

LORIMER

7922-BBR

Elevate any space with the Lorimer sconce — a sleek, capsule-shaped design crafted from glossy opal glass. Whether showcased as a statement piece or arranged in multiples along a hallway for dramatic effect, Lorimer brings effortless style. Available in two finishes: the sophisticated shine of Aged Brass or the industrial edge of matte Black Brass.

FINISHES

BLACK BRASS

Coastal Suitable Finish (EPM): No

DIMENSIONS

Height: 22"

Width/Diameter: 4.75"

Canopy/Backplate: 4.75"

Product Weight: 4.41lb

Extension: 5.25"

Top to Center: 2.25"

Canopy/Backplate Shape: Round

Sloped Ceiling Compatible: No

Living Finish: Yes

Uplight Only: No

Shade

Shade 1: Acrylic

Shade 1 Finish: White

Shade 1 Top Width: 1.75"

Shade 1 Height: 11"

Shade 2: Glass

Shade 2 Finish: Opal Shiny

Shade 2 Top Width: 4"

ELECTRICAL



Bulb 1

Bulb Included: N/A

Socket: Integrated LED

Max Wattage: 8

Bulb Quantity: 1

Bulb Included: Yes

Wire Length: 7"

Dimmer Type: TRIAC

Gem Box Required (2"x3"): No

Dark Sky: No

CRI: 90

Color Temp.: 2700k

Lumens: 350

Title 24: No

Field Serviceable: Yes

SHIPPING

Carton 1: 26" x 16" x 8"

Carton 1 Weight: 7lb

Shipping Method: Ground

Country of Origin: VN

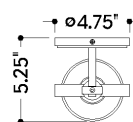

TOP

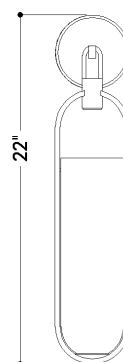

FRONT

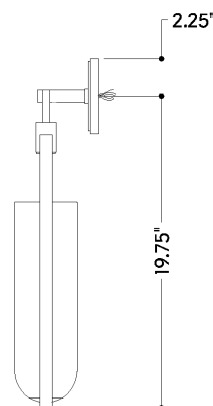

SIDE

HUDSON VALLEY
LIGHTING GROUP

| hvlgroup.com | 1.800.814.3993

REVISED 3.11.2022