

MILTON

2003-PN

The circular nose of a 19th-century locomotive lends inspiration to Milton's decorative backplate. Smooth metal rails support intricately tooled lamps, which we cap with opal glass shades. The shades are pressed to resemble pleated fabric and trimmed with contrast metal piping. Milton's attractive details add historic character to any well-appointed space.

FINISHES

POLISHED NICKEL

Coastal Suitable Finish (EPM): No

DIMENSIONS

Height: 9"

Width/Diameter: 24.75"

Canopy/Backplate: 5.5"

Product Weight: 7lb

Extension: 8.75"

Top to Center: 6"

Canopy/Backplate Shape: Round

Sloped Ceiling Compatible: No

Living Finish: No

Uplight Only: Yes

Shade

Shade 1: Glass

Shade 1 Finish: Opal Shiny

Shade 1 Top Width: 4.5"

Shade 1 Bottom L/W: 0" / 6.25"

Shade 1 Height: 5.125"

Replacement Glass Item #(s): GLS-002001



ELECTRICAL



Bulb 1

Bulb Included: No

Socket: E26 Medium Base

Bulb Type: A19

Max Wattage: 75

Bulb Quantity: 3

Wire Length: 7"

Gem Box Required (2"x3"): No

Dark Sky: No

SHIPPING

Carton 1: 28" x 18" x 10"

Carton 1 Weight: 12lb

Shipping Method: Ground

Country of Origin: VN

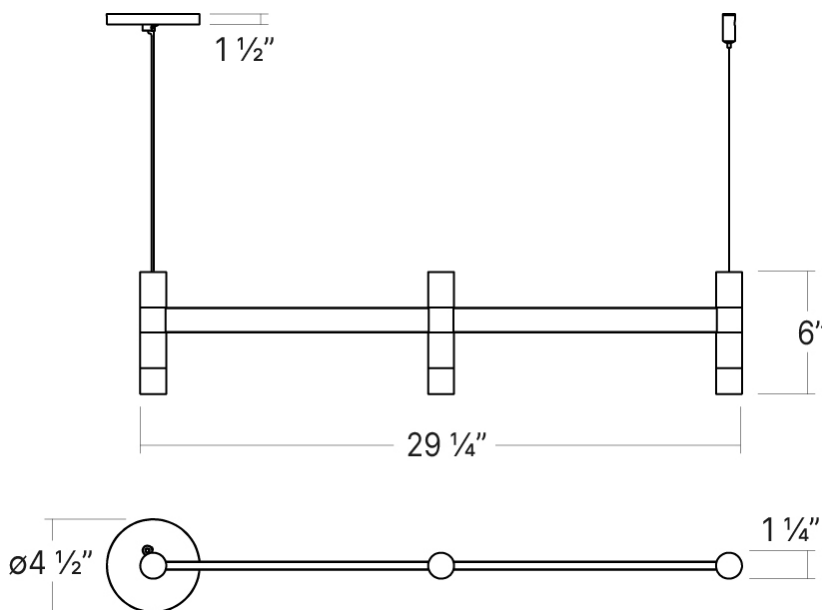

HUDSON VALLEY
LIGHTING GROUP

| hvlgroup.com | 1.800.814.3993