

SCRANTON

3015-AGB

Inspired by the shape of an apple, Scranton features a softly defined outer layer of etched glass and a narrow 'core' of shiny opal glass within. The freshness of the organic silhouette, paired with the sleek glass layers and metal accents, makes it perfect for a dining room or kitchen. Scranton is available in two sizes and two finishes, Aged Brass and Old Bronze.

FINISHES

AGED BRASS

Coastal Suitable Finish (EPM): No

DIMENSIONS

Height: 14.25"

Width/Diameter: 15"

Minimum Height: 19.25"

Maximum Height: 73"

Canopy/Backplate: 6"

Hanging Type: 1-3" / 1-6" / 1-12" / 2-18" Stems

Product Weight: 11.22lb

Canopy/Backplate Shape: Round

Sloped Ceiling Compatible: No

Living Finish: No

Uplight Only: No

Shade

Shade 1: Glass

Shade 1 Finish: Clear Etched

Shade 1 Top Width: 15"

Shade 1 Height: 13.25"

Shade 2: Glass

Shade 2 Finish: Opal Glossy

Shade 2 Top Width: 3.75"

Shade 2 Height: 12"

ELECTRICAL



Bulb 1

Bulb Included: N/A

Socket: Integrated LED

Max Wattage: 20

Bulb Quantity: 1

Wire Length: 120"

Cord Type: B & W TEFLON W/ GROUND WIRE

Dimmer Type: ELV, TRIAC

Gem Box Required (2"x3"): No

Dark Sky: No

CRI: 90

Color Temp.: 2700k

Lumens: 1575

Title 24: No

Field Serviceable: No

SHIPPING

Carton 1: 24" x 24" x 28"

Carton 1 Weight: 19lb

Shipping Method: Ground

Country of Origin: VN

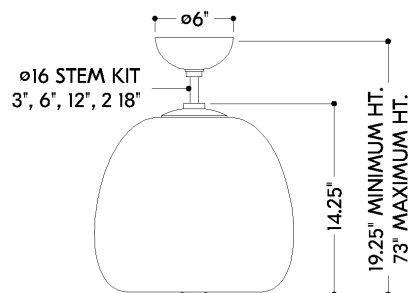

FRONT

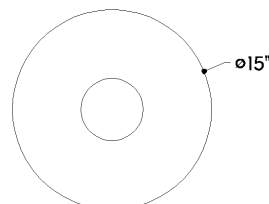

BOTTOM