

# MATEO

B2121-PBR/GRA

Inspired by the gestural curves of French designer Jean Royère's work, the Mateo sconce makes a modern statement. Its deep, swooping arm culminates in a flourish on either end, drawing the eye. The mix of Graphite and Patina Brass finishes lends additional interest to the frame. Complemented by a natural linen shade, this design-forward fixture introduces a graphic edge to any space.

## FINISHES

### PATINA BRASS w/ GRAPHITE

Coastal Suitable Finish (EPM): No

## DIMENSIONS

Height: 20.5"

Width/Diameter: 12"

Canopy/Backplate: 4.25"

Product Weight: 3.3lb

Extension: 14"

Top to Center: 11.5"

Canopy/Backplate Shape: Square

Sloped Ceiling Compatible: No

Living Finish: No

Uplight Only: Yes

## Shade

Shade 1: Fabric

Shade 1 Finish: Natural Linen

Shade 1 Top Width: 3.25"

Shade 1 Bottom L/W: 0" / 12"

Shade 1 Height: 5.5"

## ELECTRICAL



### Bulb 1

Bulb Included: No

Socket: E12 Candelabra Base

Bulb Type: B11

Max Wattage: 10

Bulb Quantity: 1

Wire Length: 7"

Cord Type: B & W TEFLON W/ GROUND WIRE

Gem Box Required (2"x3"): No

Dark Sky: No

## SHIPPING

Carton 1: 30" x 14" x 9"

Carton 1 Weight: 8lb

Shipping Method: Ground

Country of Origin: PH

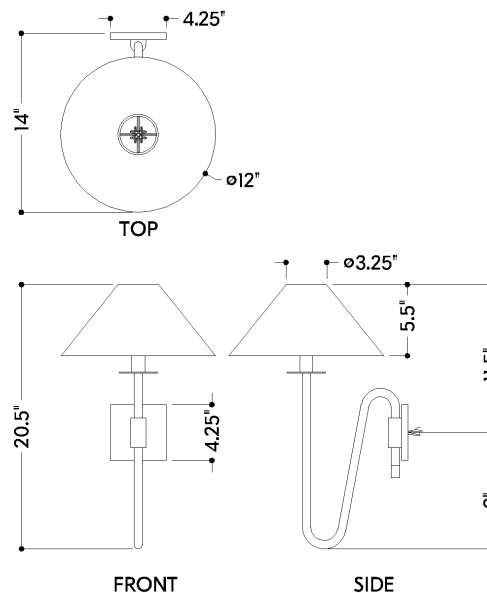

HUDSON VALLEY  
LIGHTING GROUP

| [hvlgroup.com](http://hvlgroup.com) | 1.800.814.3993