

# CONOR

B2936-PBR/GRA

Pulling from elements typically seen in pendant designs, this oversized 'rise and fall' sconce is an engineering marvel. A mid-century RLM-style shade is paired with a minimalist cylinder counterweight to create visual balance. The Patina Brass finish complements the Graphite shade and Taupe Cloth Cord while adding a layer of dimensionality to the industrial silhouette.

## FINISHES

### PATINA BRASS w/ GRAPHITE

Coastal Suitable Finish (EPM): No

## DIMENSIONS

Height: 35.5"

Width/Diameter: 17.5"

Canopy/Backplate: 4.75"

Product Weight: 9.24lb

Extension: 40.25"

Top to Center: 15.75"

Canopy/Backplate Shape: Square

Sloped Ceiling Compatible: No

Living Finish: No

Uplight Only: Yes

## Shade

Shade 1: Steel

Shade 1 Finish: Graphite

Shade 1 Top Width: 2.25"

Shade 1 Bottom L/W: 0" / 17.5"

Shade 1 Height: 16.5"

## ELECTRICAL



### Bulb 1

Bulb Included: No

Socket: E26 Medium Base

Bulb Type: G25

Max Wattage: 15

Bulb Quantity: 1

Wire Length: 7"

Cord Type: SVT TAUPE FABRIC

Gem Box Required (2"x3"): No

Dark Sky: No

## SHIPPING

Carton 1: 35" x 21" x 11"

Carton 1 Weight: 6lb

Shipping Method: Ground

Country of Origin: VN

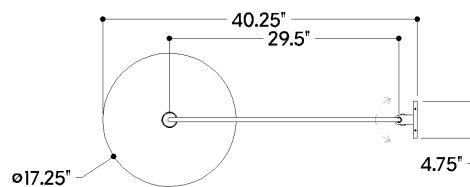

TOP

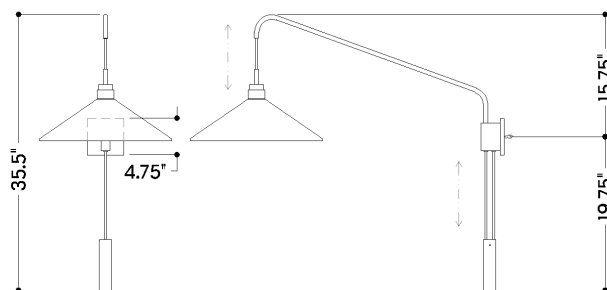

FRONT

SIDE

HUDSON VALLEY  
LIGHTING GROUP

| [hvlgroup.com](http://hvlgroup.com) | 1.800.814.3993