

# MARCO

B6214-PBR

An elevated globe sconce, Marco combines curved glass and angular metalwork to create a modern, distinctive look for the outdoors. The lantern-style hanging design features a large, clear glass orb suspended from minimalist industrial fittings. Within the shade, a ribbed glass tube conceals the light source while adding a dynamic geometric layered effect. Marco is available in two sizes with Patina Brass or Bronze finish options.

## FINISHES

### PATINA BRASS

Coastal Suitable Finish (EPM): No

## DIMENSIONS

Height: 14"

Width/Diameter: 9.5"

Canopy/Backplate: 5.25"

Product Weight: 3.52lb

Extension: 10.5"

Top to Center: 2.5"

Canopy/Backplate Shape: Round

Sloped Ceiling Compatible: No

Living Finish: Yes

Uplight Only: Yes

## Shade

Shade 1: Glass

Shade 1 Finish: Clear Inside Etched

Shade 1 Top Width: 2.75"

Shade 1 Height: 9.25"

Shade 2: Glass

Shade 2 Finish: Clear

Shade 2 Top Width: 9.5"

Shade 2 Height: 9.5"

## ELECTRICAL



### Bulb 1

Bulb Included: No

Socket: E26 Medium Base

Bulb Type: T10-5.5

Max Wattage: 10

Bulb Quantity: 1

Bulb Included: No

Wire Length: 7"

Cord Type: B & W TEFLON W/ GROUND WIRE

Gem Box Required (2"x3"): No

Dark Sky: No

## SHIPPING

Carton 1: 13" x 13" x 17"

Carton 1 Weight: 7lb

Shipping Method: Ground

Country of Origin: VN

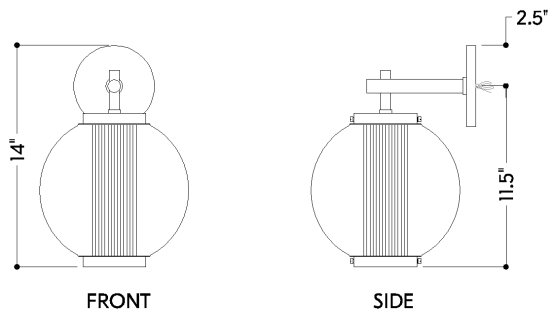
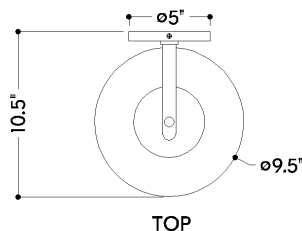

HUDSON VALLEY  
LIGHTING GROUP

| [hvlgroup.com](http://hvlgroup.com) | 1.800.814.3993

REVISED 3.11.2022