

LEONELLA

H1017301-PN

Designed specifically as bath lighting, the Leonella sconce uses a vintage-inspired botanical motif to make a subtle statement. Swooping arms in Aged Brass or Polished Nickel extend from the floral-shaped backplate, which features decorative perforations for added interest. Resembling snowdrops, the matte white bell-shaped shades provide a powerful downlight. Leonella is available with 1, 2, or 3 lights to illuminate daily routines.

FINISHES

POLISHED NICKEL

Coastal Suitable Finish (EPM): No

DIMENSIONS

Height: 8.5"

Width/Diameter: 6.25"

Canopy/Backplate: 4.75"

Product Weight: 4.4lb

Extension: 7.25"

Top to Center: 3.25"

Canopy/Backplate Shape: Round

Sloped Ceiling Compatible: No

Living Finish: No

Uplight Only: No

Shade

Shade 1: Glass

Shade 1 Finish: Opal Matte

Shade 1 Bottom L/W: 0" / 6.25"

Shade 1 Height: 6.25"

ELECTRICAL



Bulb 1

Bulb Included: No

Socket: E26 Medium Base

Bulb Type: A19

Max Wattage: 15

Bulb Quantity: 1

Wire Length: 7"

Cord Type: B & W TEFLON W/ GROUND WIRE

Gem Box Required (2"x3"): No

Dark Sky: No

SHIPPING

Carton 1: 16" x 10" x 9"

Carton 1 Weight: 5lb

Shipping Method: Ground

Country of Origin: PH

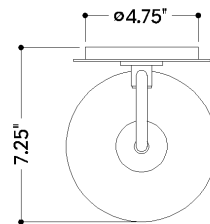

TOP

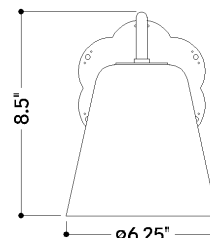

FRONT

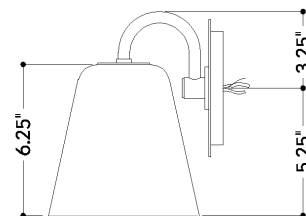

SIDE

HUDSON VALLEY
LIGHTING GROUP

| hvlgroup.com | 1.800.814.3993