

# LIBA

H884701L-AGB/SPG

A visual treat, Liba features classic forms updated with eye-catching details. Known for her color sensibility, Zoe Feldman has added a playful touch to this fixture with its unique hue. The warm neutral has a hint of pink that creates a calming, inviting presence which is complemented by the Aged Brass framework. The slender scalloped edges of the fixture allow light to shine through while adding a whimsical note. Available as a 1 or 2-light sconce and a pendant in two sizes, Liba is a thing of beauty. Part of our Zoe Feldman collection.

## FINISHES

AGED BRASS w/ SOFT PEIGNOIR

Coastal Suitable Finish (EPM): No

## DIMENSIONS

Height: 10.5"

Width/Diameter: 15"

Minimum Height: 15.5"

Maximum Height: 51"

Canopy/Backplate: 6"

Hanging Type: 1-3" / 1-6" / 1-12" / 1-18" Stems

Product Weight: 14.57lb

Canopy/Backplate Shape: Round

Sloped Ceiling Compatible: Yes

Living Finish: No

Uplight Only: No

## Shade

Shade 1: Glass

Shade 1 Finish: Opal Shiny

Shade 1 Top Width: 10.25"

Shade 1 Height: 6.25"

Shade 2: Metal

Shade 2 Finish: Soft Peignor

Shade 2 Top Width: 11.75"

Shade 2 Height: 15"

## ELECTRICAL



### Bulb 1

Bulb Included: No

Socket: E26 Medium Base

Bulb Type: A19

Max Wattage: 15

Bulb Quantity: 1

Bulb Included: No

Wire Length: 120"

Gem Box Required (2"x3"): No

Dark Sky: No

## SHIPPING

Carton 1: 18" x 12" x 10"

Carton 1 Weight: 19lb

Shipping Method: Ground

Country of Origin: VN

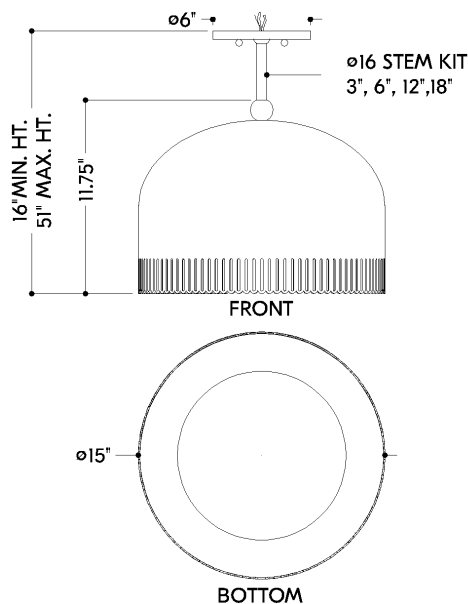

HUDSON VALLEY  
LIGHTING GROUP

| hvlgroup.com | 1.800.814.3993

REVISED 3.11.2022