

CATRINE

H933701S-AGB

An elevated kitchen basic, Catrine is characterized by uncomplicated forms, industrial design details, and a refreshing blend of materials. This pendant features a large globe suspended by an oversized pin and loop, finished in Aged Brass. To soften the clean lines, grass cloth wraps around the pin, introducing a natural element to the modern silhouette.

*Due to the one-of-a-kind nature of the medium, exact colors and patterns may vary slightly from the image shown.

FINISHES

AGED BRASS

DIMENSIONS / SPECS

Height: 17.75"

Width/Diameter: 12"

Minimum Height: 20.75"

Maximum Height: 72.25"

Canopy/Backplate: 5.5"

Hanging Type: 54" Chain

Product Weight: 6.1lb

Canopy/Backplate Shape: Round

Sloped Ceiling Compatible: Yes

Living Finish: No

Uplight Only: Yes

Shade 1: Glass

Shade 1 Finish: Clear

Shade 1 Top Width: 12"

Shade 1 Bottom L/W: 0" / 4.75"

Shade 1 Height: 11.25"

ELECTRICAL



Bulb 1

Bulb Included: No

Socket: E26 Medium Base

Bulb Type: G25

Max Wattage: 15

Bulb Quantity: 1

Wire Length: 120"

Cord Type: SPT-1 SILVER W/ TINNED GROUND WIRE

Gem Box Required (2"x3"): No

Dark Sky: No

SHIPPING

Carton 1: 17" x 16" x 16"

Carton 1 Weight: 10lb

Shipping Method: Ground

Country of Origin: VN

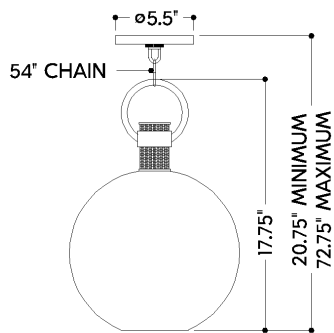

FRONT

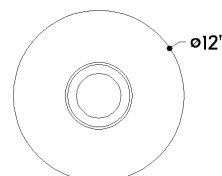

BOTTOM

HUDSON VALLEY
LIGHTING GROUP