

SARAI

L3229-AGB/CMT

Featuring an irregular rectangular base with a geometric pattern, the Sarai table lamp is a sculptural beauty. The base is playfully adorned with a series of rectangular and square ledges, finished in a soft moonstone granite glaze. The large white linen drum shade contrasts the planar base while adding to the overall visual weight.

*Due to the one-of-a-kind nature of the medium, exact colors and patterns may vary slightly from the image shown.

FINISHES

AGED BRASS w/ Ceramic Moonstone Granite
Coastal Suitable Finish (EPM): No

DIMENSIONS

Height: 29.25"
Width/Diameter: 19"
Canopy/Backplate: 6"
Product Weight: 12.6lb
Canopy/Backplate Shape: Square
Sloped Ceiling Compatible: No
Living Finish: No
Uplight Only: No

Shade

Shade 1: Textile
Shade 1 Finish: White Linen
Shade 1 Top Width: 17.5"
Shade 1 Bottom L/W: 0" / 19"
Shade 1 Height: 12.5"
Shade 2: Textile
Shade 2 Finish: White Linen
Shade 2 Top Width: 16.5"

ELECTRICAL



Bulb 1

Bulb Included: No
Socket: E26 Medium Base
Bulb Type: A19
Max Wattage: 15
Bulb Quantity: 1
Wire Length: 96"
Cord Type: SPT-2 BLACK FABRIC
Switch Type: FULL RANGE DIMMER ON
SOCKET
Gem Box Required (2"x3"): No
Dark Sky: No

SHIPPING

Carton 1: 21" x 21" x 35"
Carton 1 Weight: 27lb
Shipping Method: Ground
Country of Origin: VN

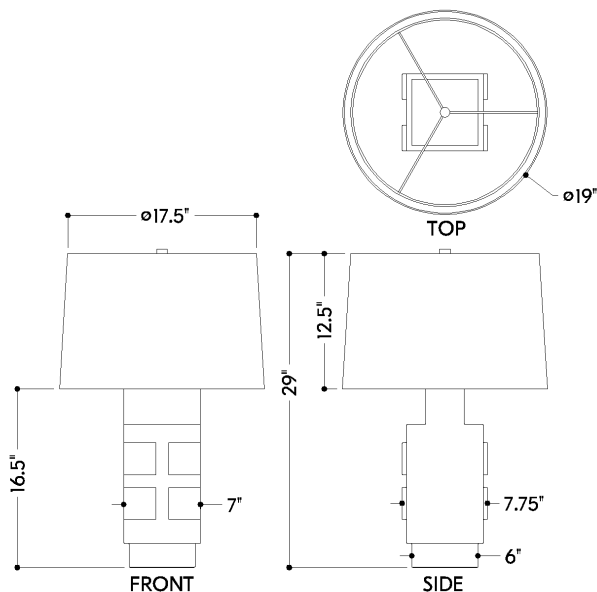

HUDSON VALLEY
LIGHTING GROUP

| hvlgroup.com | 1.800.814.3993