

LEESTON

L4127-AGB/CMS

Drawing inspiration from ancient Greek pottery, the Leeston family includes two geometric ceramic table lamps that appear carved from a larger block. The smaller lamp takes the shape of a perfect sphere, while the larger lamp features an oblong pill shape. Both are finished in soft matte glazes and topped with fresh white linen drum shades.

FINISHES

AGED BRASS w/ Ceramic Moonstone Sand

Coastal Suitable Finish (EPM): No

DIMENSIONS

Height: 27"

Width/Diameter: 16"

Canopy/Backplate: 7.5"

Product Weight: 10.1lb

Canopy/Backplate Shape: Cylinder

Sloped Ceiling Compatible: No

Living Finish: No

Uplight Only: No

Shade

Shade 1: Linen

Shade 1 Finish: White

Shade 1 Top Width: 14.5"

Shade 1 Bottom L/W: 0" / 16"

Shade 1 Height: 11"

Shade 2: Linen

Shade 2 Finish: White

Shade 2 Top Width: 13.75"

ELECTRICAL



Bulb 1

Bulb Included: No

Socket: E26 Medium Base

Bulb Type: A19

Max Wattage: 15

Bulb Quantity: 1

Bulb Included: No

Wire Length: 96"

Cord Type: SPT-2 BLACK FABRIC

Switch Type: FULL RANGE DIMMER ON

SOCKET

Gem Box Required (2"x3"): No

Dark Sky: No

SHIPPING

Carton 1: 19" x 19" x 32"

Carton 1 Weight: 21lb

Shipping Method: Ground

Country of Origin: VN

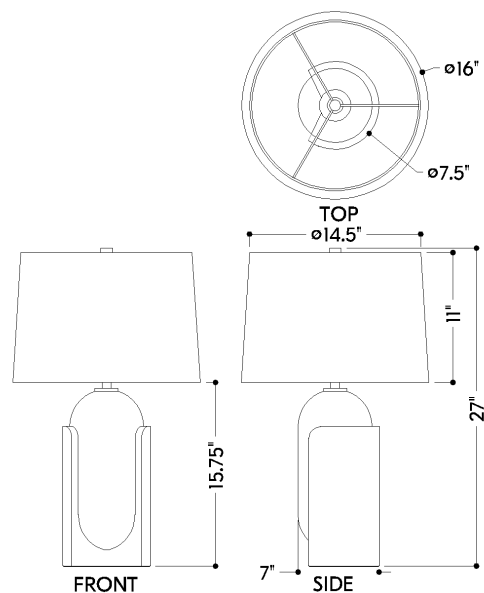

HUDSON VALLEY
LIGHTING GROUP

| hvlgroup.com | 1.800.814.3993

REVISED 3.11.2022