

# MONTVILLE

L6329-AGB/C05

Capturing the colors of sand and sea with a mesmerizing drip effect, this ceramic table lamp is a serene addition to modern interiors. The painterly effect of Montville gives it a fresh-from-the-studio feel, while the glaze reflects light. Topped with a large linen drum shade and finished with Aged Brass metalwork, Montville makes for an artful bedside or living room accent piece.

## FINISHES

**AGED BRASS w/ Ceramic Crackle Emerald Tide**  
Coastal Suitable Finish (EPM): No

## DIMENSIONS

Height: 28.5"  
Width/Diameter: 19"  
Canopy/Backplate: 6"  
Product Weight: 12.1lb  
Canopy/Backplate Shape: Round  
Sloped Ceiling Compatible: No  
Living Finish: No  
Uplight Only: No

## Shade

Shade 1: Linen  
Shade 1 Finish: White  
Shade 1 Top Width: 15.75"  
Shade 1 Bottom L/W: 0" / 19"  
Shade 1 Height: 12"

## ELECTRICAL



### Bulb 1

Bulb Included: No  
Socket: E26 Medium Base  
Bulb Type: A21  
Max Wattage: 25  
Bulb Quantity: 1  
Bulb Included: No  
Wire Length: 96"  
Cord Type: SPT-2 BLACK FABRIC  
Switch Type: FULL RANGE DIMMER ON  
SOCKET  
Gem Box Required (2"x3"): No  
Dark Sky: No

## SHIPPING

Carton 1: 22" x 20" x 20"  
Carton 1 Weight: 16lb  
Shipping Method: Ground  
Country of Origin: VN

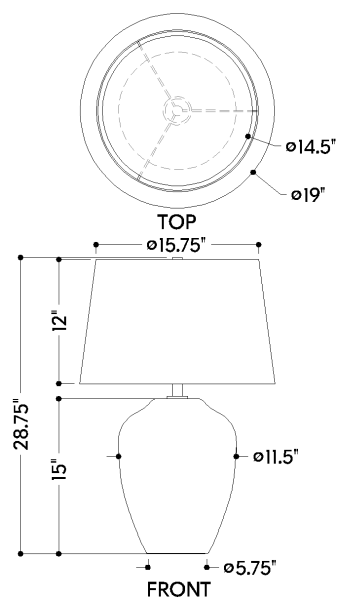

HUDSON VALLEY  
LIGHTING GROUP

| [hvlgroup.com](http://hvlgroup.com) | 1.800.814.3993

REVISED 3.11.2022