

# NAHANT

L7329-VGL/CWD

The dynamically sculpted white dune ceramic body of Nahant appears to have been weathered by sand over time. The striations of color create an organic effect reminiscent of natural stone. Balanced by an off-white linen shade, this table lamp has a warm and inviting presence.

## FINISHES

### VINTAGE GOLD LEAF

Coastal Suitable Finish (EPM): No

## DIMENSIONS

Height: 29"

Width/Diameter: 18"

Canopy/Backplate: 8.25"

Product Weight: 16.5lb

Canopy/Backplate Shape: Round

Sloped Ceiling Compatible: No

Living Finish: No

Uplight Only: No

## Shade

Shade 1: Linen

Shade 1 Finish: Off White

Shade 1 Top Width: 16"

Shade 1 Bottom L/W: 0" / 18"

Shade 1 Height: 12"

## ELECTRICAL



### Bulb 1

Bulb Included: No

Socket: E26 Medium Base

Bulb Type: A19

Max Wattage: 15

Bulb Quantity: 1

Bulb Included: No

Wire Length: 96"

Switch Type: Full Range Dimmer

Gem Box Required (2"x3"):

Dark Sky: No

## SHIPPING

Carton 1: 35" x 23" x 23"

Carton 1 Weight: 31lb

Shipping Method: Ground

Country of Origin: PH

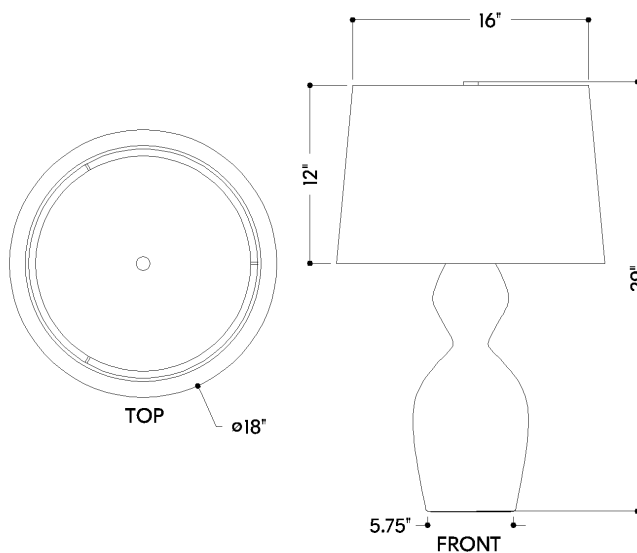

HUDSON VALLEY  
LIGHTING GROUP

| [hvlgroup.com](http://hvlgroup.com) | 1.800.814.3993

REVISED 3.11.2022