

CLEO

H833101-AGB

Inspired by a crystal ball, Cleo brings a sense of mysticism to modern spaces. Handcrafted from beautiful Nuage Glass, a large orb is supported by a cantilever in a warm Aged Brass finish. The shade crafted from Opal Glass rests inside, creating a layered diffusion of light. The opaque swirled patterns of the glass glow when lit.

FINISHES

AGED BRASS

Coastal Suitable Finish (EPM): No

DIMENSIONS

Height: 9.75"

Width/Diameter: 7.5"

Canopy/Backplate: 4.5"

Product Weight: 4.95lb

Extension: 8.5"

Top to Center: 5"

Canopy/Backplate Shape: Rectangle

Sloped Ceiling Compatible: No

Living Finish: No

Uplight Only: Yes

Shade

Shade 1: Glass

Shade 1 Finish: White

Shade 1 Top Width: 7.5"

Shade 1 Height: 6.5"

ELECTRICAL



Bulb 1

Bulb Included: No

Socket: E26 Medium Base

Bulb Type: G25

Max Wattage: 15

Bulb Quantity: 1

Bulb Included: No

Wire Length: 7"

Gem Box Required (2"x3"): No

Dark Sky: No

SHIPPING

Carton 1: 22" x 12" x 11"

Carton 1 Weight: 8lb

Shipping Method: Ground

Country of Origin: VN

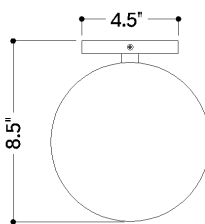

TOP

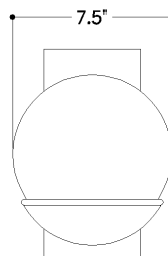

FRONT

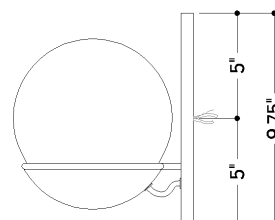

SIDE

HUDSON VALLEY
LIGHTING GROUP

| hvlgroup.com | 1.800.814.3993

REVISED 3.11.2022